

Thomas Court, Flat 6, Flat 6, Marlborough Road, Cardiff, Caerdydd
Approximate Gross Internal Area
589 Sq Ft/55 Sq M

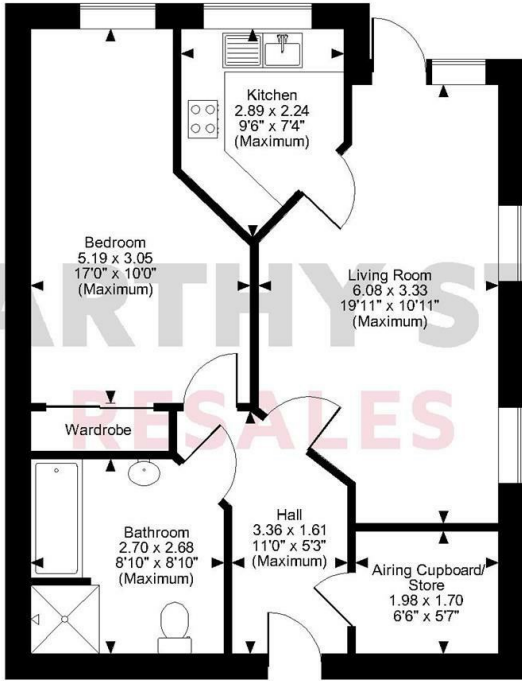

Ground Floor

FOR ILLUSTRATIVE PURPOSES ONLY - NOT TO SCALE
The position & size of doors, windows, appliances and other features are approximate only.
© ehouse. Unauthorised reproduction prohibited. Drawing ref. dig/8599812/CTH

Council Tax Band: D

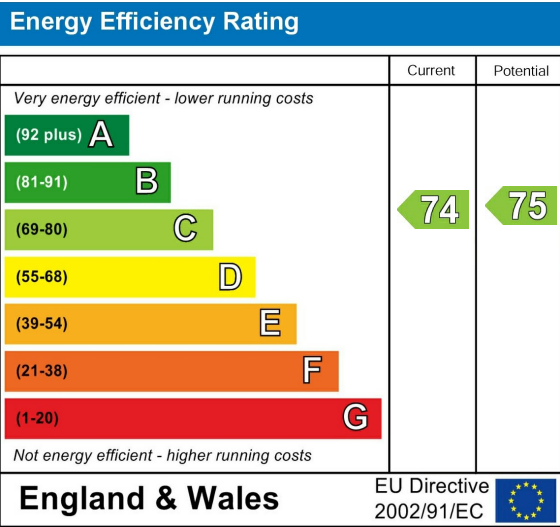
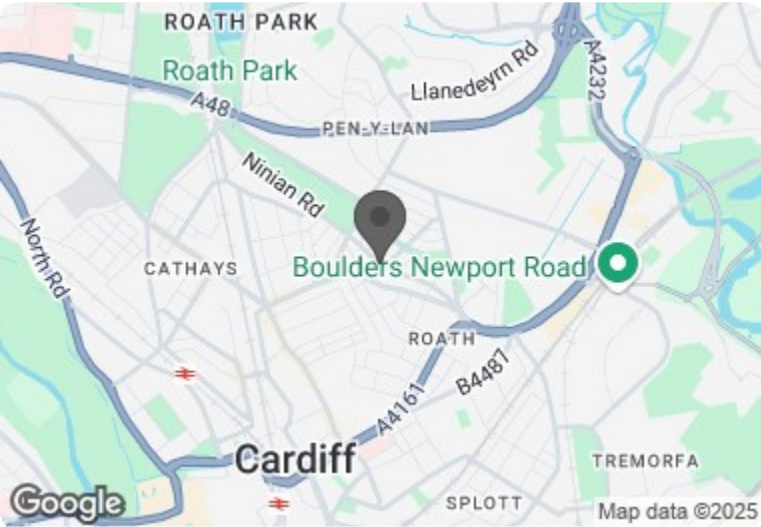

This floor plan is not drawn to scale and is for illustrative purposes only. Any measurements, floor areas (including any total floor area), openings and orientation are approximate and for guidance only. McCarthy Stone Resales do not take liability for any error, omission or misstatement. All parties must rely on their own inspections. It should not be assumed that any furniture or fittings contained in the photographs are included in any sale. All details referring to time and distances to localities are approximate. Details regarding any common charges and other applicable fees are provided by the seller and should not be relied on without verification and further checks made through a solicitor/conveyancer. Please contact the Property Consultant for further information that Appliances (including central heating) have not been tested, therefore it cannot be assumed that they are in good working order. All interested parties are advised to check availability and make an appointment before travelling to view the property to avoid disappointment or wasted time or travel expenses. The details contained within this brochure are for information purposes only and do not form part of any agreement. All purchases will be subject to contract terms. © All artwork (photos and floorplans) and written content are the sole property and copyright of McCarthy & Stone Resales Limited and are legally protected by UK & International copyright laws. Under no circumstance may you download, reproduce, publish or distribute any content for commercial purposes, without prior written permission from McCarthy Stone Resales. Unauthorised duplication or usage for commercial purposes is prohibited by the Copyright law and will be prosecuted.



19 Thomas Court

Marlborough Road, Cardiff, CF23 5EZ

PRICE
REDUCED



PRICE REDUCTION

Asking price £210,000 Leasehold

Very well presented one bedroom, ground floor retirement apartment with direct access out on to a pretty patio area. Thomas Court offers quality care services delivered by McCarthy Stone experienced CQC registered Estates team.

On Site Restaurant *Energy Efficient* *Pet Friendly*

Call us on 0345 556 4104 to find out more.

Thomas Court, Marlborough Road, Cardiff

1 Bed | £210,000

PRICE
REDUCED

Introduction:

Constructed in late summer 2013 by renowned retirement home specialists McCarthy Stone, Thomas Court is consistently one of our most sought-after developments. This is a 'Retirement Living Plus' development providing a lifestyle living opportunity for the over 70's and designed specifically for independent living with the peace-of-mind provided by the day-to-day support of our excellent staff and Estate Manager who oversees the smooth running of the development.

The property enjoys excellent communal facilities including a Homeowners' lounge, restaurant with a fantastic, varied and subsidised daily table-service lunch, laundry room, mobility scooter store and landscaped gardens. Homeowners also benefit from one hour of domestic assistance each week and there are also extensive domestic and care packages available to suit individual needs and budgets. All apartments are equipped with a 24-hour emergency call facility and sophisticated intercom system providing both a visual and verbal link to the main development entrance. There is also the excellent guest suite widely used by visiting family and friends for which a small charge of £25 per night applies.

It's so easy to make new friends and to lead a busy and fulfilled life at Thomas Court. There are always plenty of regular activities to choose from including; a choir, art group, fitness classes, coffee mornings, games and quiz nights, themed events and occasional organised trips. Whilst there is something for everyone there is certainly no obligation to participate and home owners 'dip in and out' of activities as they wish. The development is in an excellent position within a level walk of extensive amenities; shops, Doctors, library, park and bus routes are all close at hand.

Entrance Hall:

With a solid Oak-veneered entrance door with spy-hole, security intercom system that provides both a visual (via the home-owners TV) and verbal link to the main development entrance door. Emergency pull cord, walk-in cupboard housing the Gledhill boiler supplying domestic hot water, light and shelving,

Living Room:

A lovely, welcoming living room with double glazed door with matching side panel opening on to a small patio area. Feature fireplace with inset electric fire. Feature glazed panelled door leads to the kitchen.

Kitchen:

With a double-glazed electronically operated window. Excellent range of pale wood effect fitted wall and base units with contrasting laminate worktops and incorporating a stainless steel inset sink. Integrated appliances include; a four-ringed hob with stainless steel chimney extractor hood over and high level double oven. Space for fridge/freezer, ceiling spot light fitting, extensively tiled walls and fully tiled floor.

Double Bedroom:

A lovely well-proportioned double bedroom. Double-glazed window, fitted double wardrobe with ample hanging space, shelving and mirror fronted sliding doors. Ceiling light fitting.

Bathroom/Shower Room

Modern white suite comprising; close-coupled WC, vanity wash-hand basin with under sink storage, fitted mirror with strip light and shaver point, panelled bath and a walk-in level access shower with thermostatically controlled shower. Fully tiled walls and wet room vinyl flooring, electric heated towel rail/radiator, emergency pull cord and ceiling spot light.

Parking

Car parking is available with a yearly permit at a charge of around £250 per annum (subject to availability).

Leasehold:

Lease 125 Years From January 2013
Ground Rent: £435 per annum
Ground Rent Review Date: January 2028

Service Charge

What your service charge pays for:

- Estate Manager who ensures the development runs smoothly
- CQC Registered care staff on-site 24/7 for your peace of mind
- 1 hour cleaning / domestic assistance per week, per apartment
- Underfloor heating in individual apartments

- 24hr emergency call system
- Monitored fire alarms and door camera entry security systems
- Maintaining lifts
- Heating and lighting in communal areas
- The running costs of the onsite restaurant
- Cleaning of communal areas daily
- Cleaning of windows
- Maintenance of the landscaped gardens and grounds
- Repairs & maintenance to the interior communal areas
- Contingency fund including internal and external redecoration of communal areas
- Buildings insurance, water and sewerage rates

The service charge does not cover external costs such as your Council Tax, electricity or TV. Find out more about service charges please contact your Property Consultant or Estate Manager.

Service Charge: £9,515.62 per annum (up to financial year end 31/03/2025).

Ask about our FREE ENTITLEMENTS SERVICE to find out what benefits you may be entitled to to support you with service charges and living costs. (Often offset by Government Entitlements e.g. Attendance Allowance £3,500-£5,200pa).

MOVING MADE EASY

Moving is a huge step, but don't let that hold you back. We have a range of services to help your move go smoothly, including:

- FREE Entitlements Advice to help you find out what benefits you may be entitled to that can assist with service charges or living costs.
- Part Exchange service to help you move without the hassle of having to sell your own home.
- Removal Services that can help you declutter and move you in to your new home.
- Conveyancing specialists who are experienced with sales and purchases of McCarthy Stone retirement properties.

For more information speak with our Property Consultant today.

Additional Information & Services

- Ultrafast Full Fibre Broadband available
- Mains water and electricity
- Electric room heating
- Mains drainage

